

# Vision 2020



Christ Church  
Aughton

# Re-ordering the inside of Christ Church Aughton

*Bible Motto verse: Proverbs 3:5-6*

*Trust in the Lord with all your heart and  
lean not on your own understanding;  
in all your ways submit to him,  
and he will make your paths straight.*

## **WHY:**

We have a wonderful church building that is now over 150 years old. While we greatly appreciate the beauty of the historic church building, we are aware that there are some aspects of it which make it less than ideal for ministry in the 21st Century.

Some find it cold, uncomfortable, formidable, and unapproachable. While disabled people can enter the church building, there are no appropriate toilet facilities and the chancel, altar rail and vestry area are not accessible to those in wheelchairs.

The audio-visual system requires updating to improve accessibility to all parts of the service, particularly improving the sound quality and enhancing the experience for those who are hard of hearing.

The music group is currently set in a corner out of direct sight of a large part of the congregation, which is not ideal in enabling

them to lead effective worship.

The current entrance is welcoming but the side door is difficult to find for those who are new to the church.

The project has been driven by a desire to honour God, provide a welcoming church that meets the needs of ministry in 21st Century, is accessible to all and enables more people to come to know Jesus as their personal saviour.

The church community has been discussing the layout of the church interior building for a number of years, with the plans evolving and adapting over time.

The current project arose out of the **PCC/Ministry Team Vision Day** in September 2019. On that day we looked at prayer/worship, sharing LYFE together and Mission.

We believe that the proposed changes to the church building are in line with the aims which arose from the discussions that day.

We very much desire that Christ Church's building be a place that . . .

- \* **Is welcoming to all**
- \* **Facilitates our worship of God and meeting with Him.**
- \* **Encourages the development of fellowship**
- \* **Is flexible, allowing it to be used seven days a week**

## Planned Improvements

- \* **Comfort - underfloor heating and comfortable seating**
- \* **Accessibility - particularly to chancel and vestry, disabled toilet**
- \* **Hospitality - a new kitchen area**
- \* **Layout - better visibility for worship leaders**
- \* **Room development - to allow more flexible building use**

## Process to date

2019: PCC set up a 'Vision 2020' committee

**Rev Sarah O'Donoghue**

**Liz Mawdsley** (PCC 2019-2022 Fabric)

**David Dennison** (joined 2021)

**Joe Johnson** (PCC member)

**Jonathan Lock** (PCC member)

**Rikki Abernethy** (Ministry Team)

**John Appleton** (Stewardship committee)

The group has met regularly, although interrupted by COVID, and has sought outside advice and guidance from many individuals and groups including:

**Architect** - Bill Schafer, who has very wide experience in advising and drawing up plans for churches. He knows our church building very

well, having carried out the Diocesan Quinquennial inspection of Christ Church for over 20 years.

Members of Diocesan Advisory Group  
Church Heating Engineer advisor

Advice from church leaders that have been involved in similar projects

Visits to other churches that have reordered their interior.

## Consultation Process

- \* **PCC - 13th September 2022**
- \* **Church members - October/November 2022**
- \* **Plans presented to community Saturday 19th November 2022**
- \* **Consultation with Victorian Society**

## Next Steps

- \* **Review/revision of plans by Vision 2020 committee in light of constructive feedback**
- \* **Estimates from three building firms with appropriate experience**
- \* **Further consultation with PCC**
- \* **Submission of plans for consideration/ approval by Faculty to Diocesan Advisory Committee**

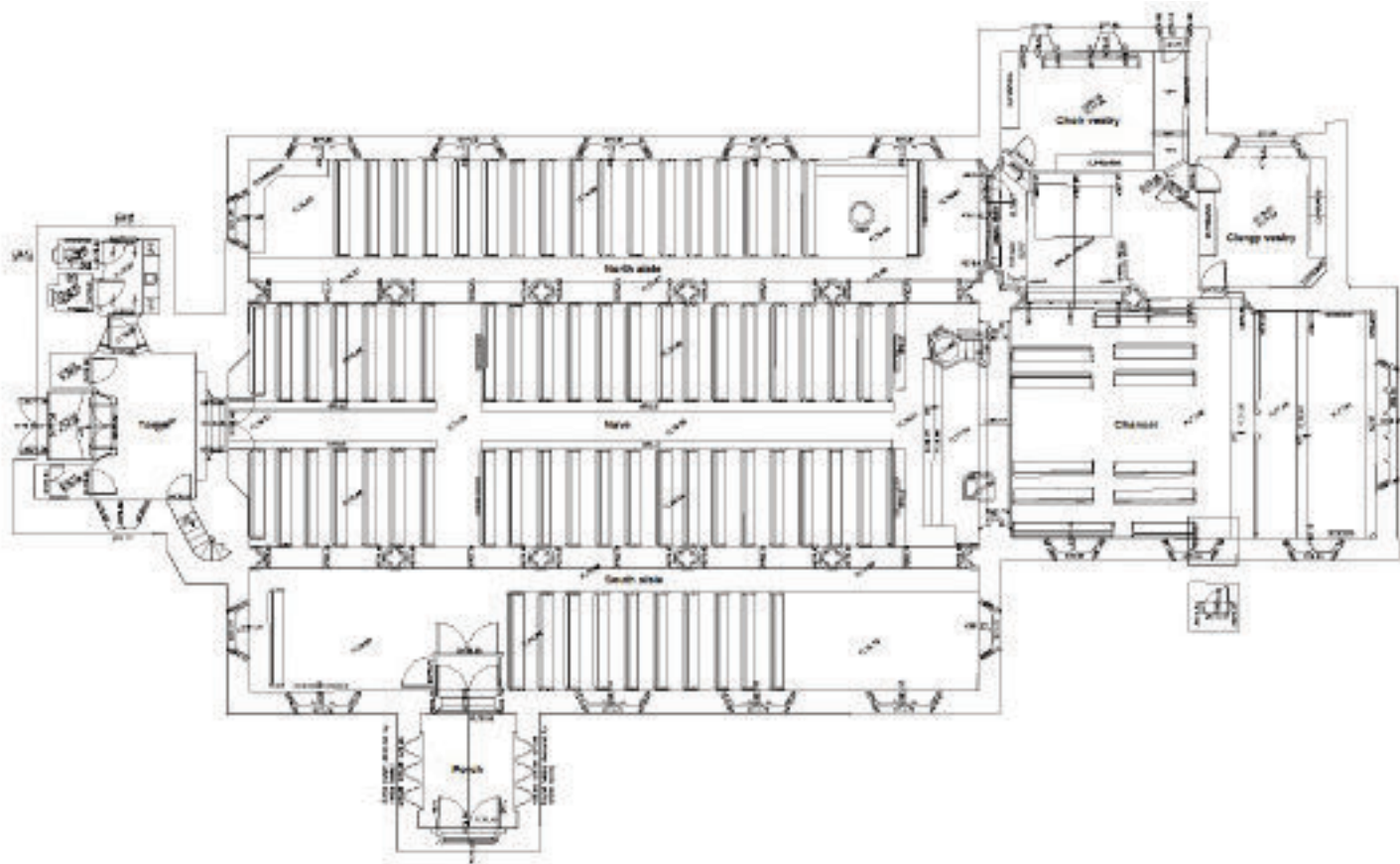

**Christ Church Aughton**  
**EXISTING PLAN**

## Particular features of Plans

### PHASE 1 - WEST END

- \* Glass doors entrance - light, and welcoming
- \* Straight entrance - disability friendly
- \* Opening up the church - glass doors focusing on heat preservation, with clear view into church interior
- \* Underfloor heating to the back of the church
- \* New accessible disabled toilet
- \* New kitchen area in current library corner with section of lower counter enabling wheelchair and children access and space for cold drinks.
- \* Wide counter enables cupboard space to be provided on both sides.
- \* Chairs rather than pews in back area - to allow greater flexibility with use of space with includes provision for different/variety of users/uses during the week

### PHASE 2 - EAST END

- \* Underfloor heating throughout - radiant heating effectively heats to 2 metres, with constant lower-level background heating.

- \* Ramp to run along north wall - to enable disabled access to “choir room / vestry” area and via these to chancel area
- \* Enlarge/redesign of chancel area to provide flexibility in the layout of the worship space - allowing the Music group/organ to be re-sited to an enlarged chancel area - enabling more effective/inclusive worship
- \* Replacement of some or all of pews with stackable chairs - up to 40 at a time can be stored under the window in the current music corner
- \* Replacement of gas boiler
- \* Redesign vestry/organ loft area to provide enclosed areas/rooms that can be used for Diddy Disciples, group meetings, or small services

## FINANCES

- \* Phased project
- \* Significant finance already available due to legacies and giving expected to cover much if not all of Phase 1 of project
- \* Application for grants



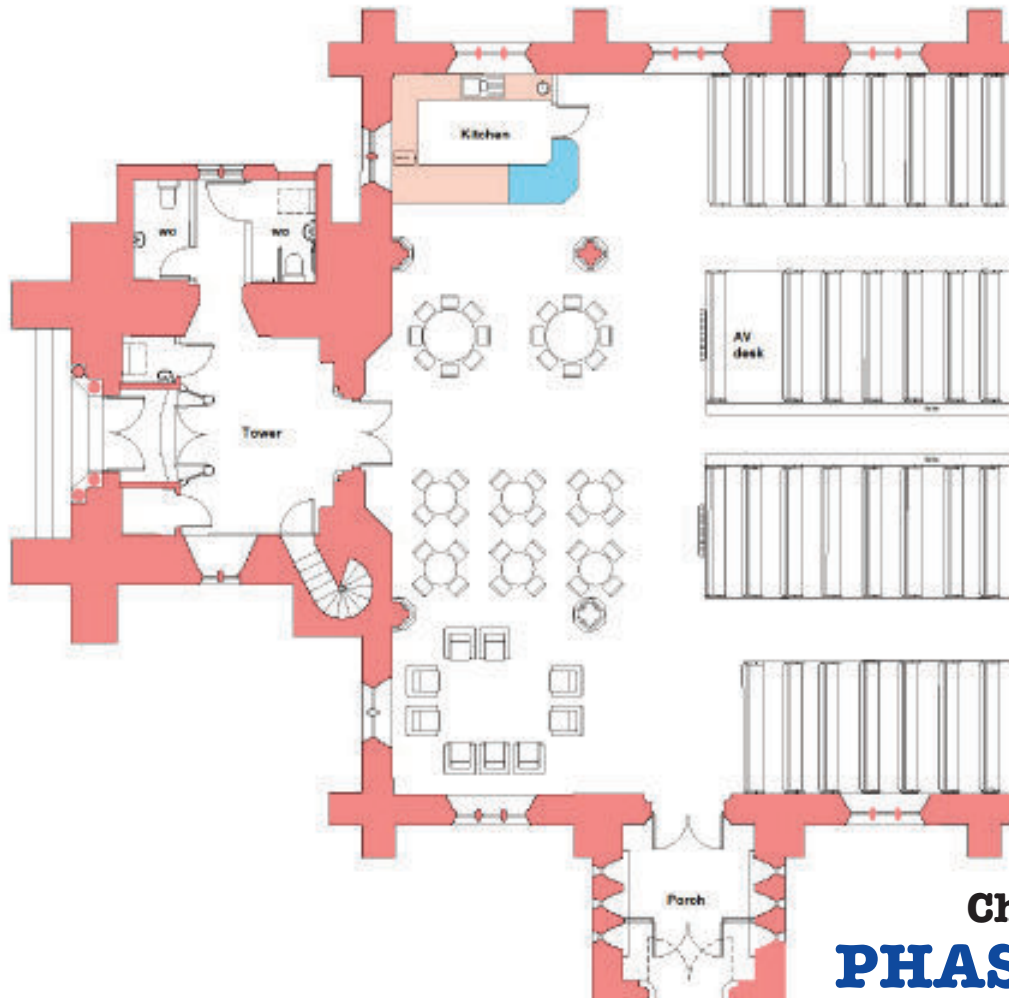

**Christ Church Aughton**  
**PHASE ONE PLAN**

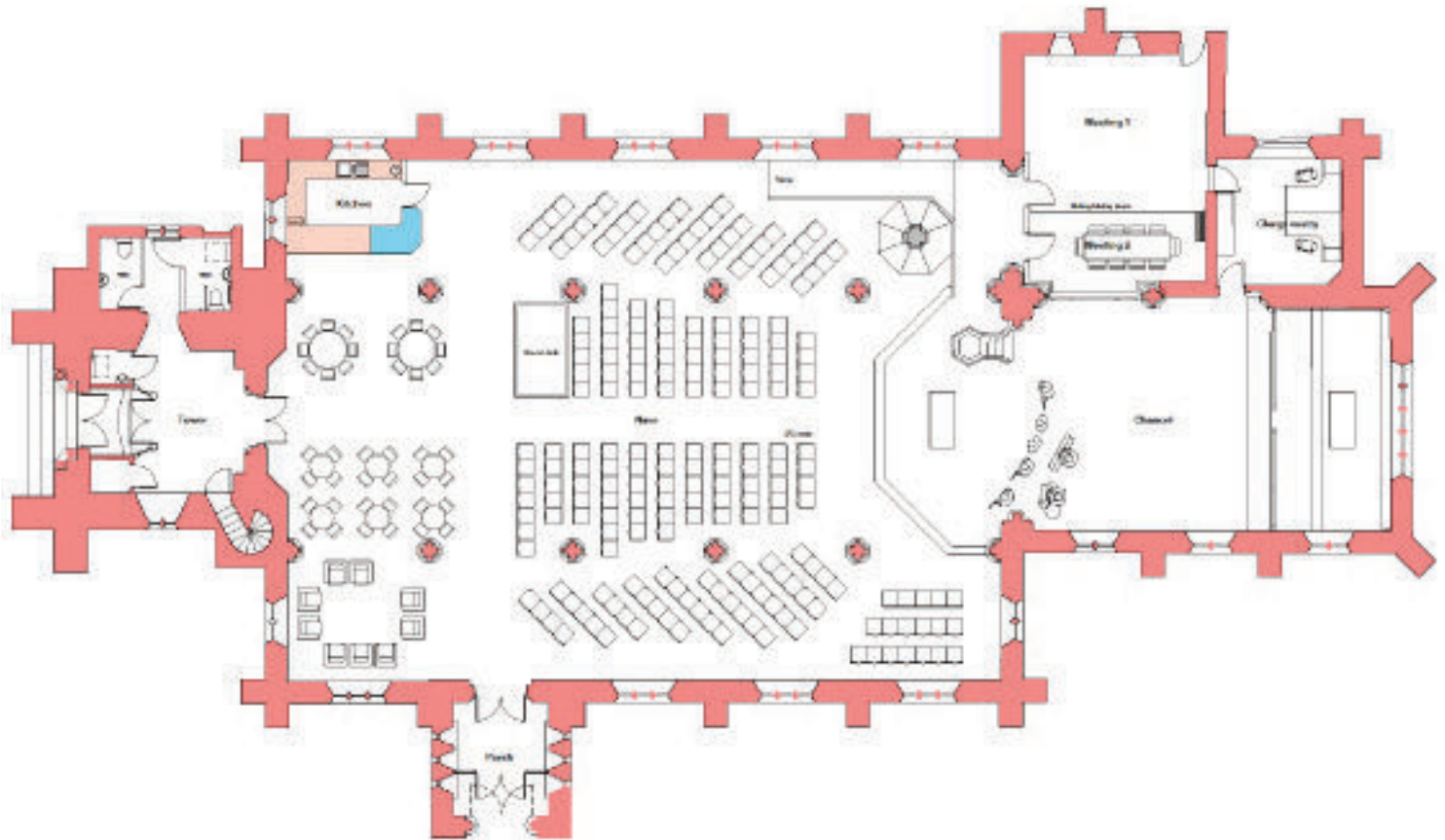

**Christ Church Aughton**  
**PHASE ONE and TWO PLAN**

*Bible Motto - 2019: Jeremiah 29:11*

*“For I know the plans I have for you,” declares the Lord, “plans to prosper you and not to harm you, plans to give you hope and a future.”*

*Bible Motto - 2020: Ephesians 3:20*

*Now to him who is able to do immeasurably more than all we ask or imagine, according to his power that is at work within us, to him be glory in the church and in Christ Jesus throughout all generations, for ever and ever.*



**Christ Church  
Aughton**

The **2020 vision group** welcome your constructive comments.

Please complete a feedback form available in church and return it to the Office or to the back of church by

**Sunday 27th November 2022**

